



Installation Instructions (Page 1)

Toyota Tacoma/Hilux 05+ Front Coil Overs

King Shocks 12472 Edison Way Garden Grove, CA 92841
714-530-8701 www.kingshocks.com



(1) With the vehicle on level ground, set the emergency brake and block the rear tires. Using a floor jack, raise the front end and support the frame rails with jack stands for safety. Then remove the front tires. **NOTE: Never work under an unsupported vehicle.**



(2)

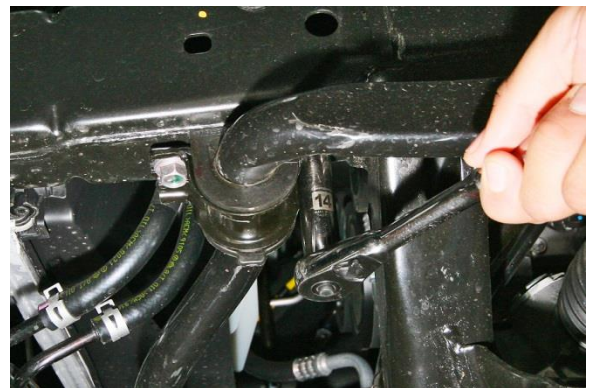

(2)

(2) Remove the sway bar end link from the spindle. Remove the bolts holding the sway bar to the chassis.



(3)

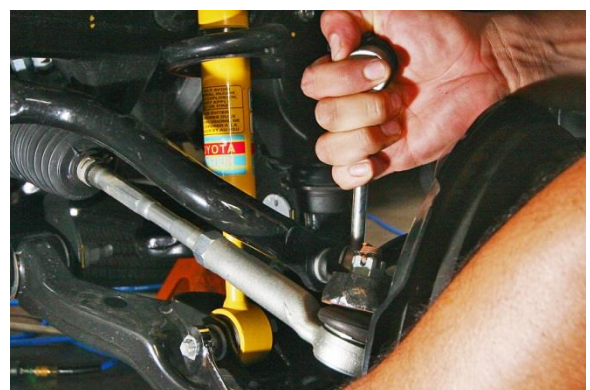

(3)

(3) Remove the nuts from the upper and lower shock mounts but leave the bottom bolt in for now.

IMPORTANT: Read all instructions thoroughly from start to finish before beginning the install. Check parts list and make sure all parts are included in the kit. If the instructions are not properly followed severe frame, driveline and or suspension damage may result. Check for frame and suspension damage prior to installation

This kit does not require welding. Do not weld on any component. Welding may void the warranty and/or cause the product to fail. If any parts are missing, or for tech assistance; Contact King Off Road Racing Shocks. 714-530-8701



Installation Instructions (Page 2)

Toyota Tacoma/Hilux 05+ Front Coil Overs

King Shocks 12472 Edison Way Garden Grove, CA 92841
714-530-8701 www.kingshocks.com

(4)



(4)



(4) Remove the bolt holding the ABS line from the spindle. While holding the ABS line out of the way, remove the lower shock bolt and pull the factory shock out from the bottom.

(5)



(5)



(5)



(5) Insert the new King Shock from below taking care not to damage the ABS line. Start the mounting bolts through the top shock mount into the top plate but don't fully tighten them. Insert the rod end into the lower mount then tighten all the bolts.

IMPORTANT: Read all instructions thoroughly from start to finish before beginning the install. Check parts list and make sure all parts are included in the kit. If the instructions are not properly followed severe frame, driveline and or suspension damage may result. Check for frame and suspension damage prior to installation

This kit does not require welding. Do not weld on any component. Welding may void the warranty and/or cause the product to fail. If any parts are missing, or for tech assistance; Contact King Off Road Racing Shocks. 714-530-8701



Installation Instructions (Page 3)

Toyota Tacoma/Hilux 05+ Front Coil Overs

King Shocks 12472 Edison Way Garden Grove, CA 92841
714-530-8701 www.kingshocks.com



(6)



(6)

(6) Re-attach the sway bar end link. Bolt the remote reservoir mount into the sway bar mount holes with the supplied M10 x 40mm allen head bolts.



(7)



(7)

(7) Bolt the sway bar to the bottom of the remote reservoir mount with the supplied 3/8 x 3/4" bolts then install the reservoir with the supplied band clamps. Repeat the same steps on the opposite side.

IMPORTANT: Read all instructions thoroughly from start to finish before beginning the install. Check parts list and make sure all parts are included in the kit. If the instructions are not properly followed severe frame, driveline and or suspension damage may result. Check for frame and suspension damage prior to installation

This kit does not require welding. Do not weld on any component. Welding may void the warranty and/or cause the product to fail. If any parts are missing, or for tech assistance; Contact King Off Road Racing Shocks. 714-530-8701



Installation Instructions (Page 4)

Toyota Tacoma/Hilux 05+ Front Coil Overs

King Shocks 12472 Edison Way Garden Grove, CA 92841
714-530-8701 www.kingshocks.com

Your install should look similar to the photos below. The top picture shows the Tacoma style setup. The bottom pictures shows The Hilux version

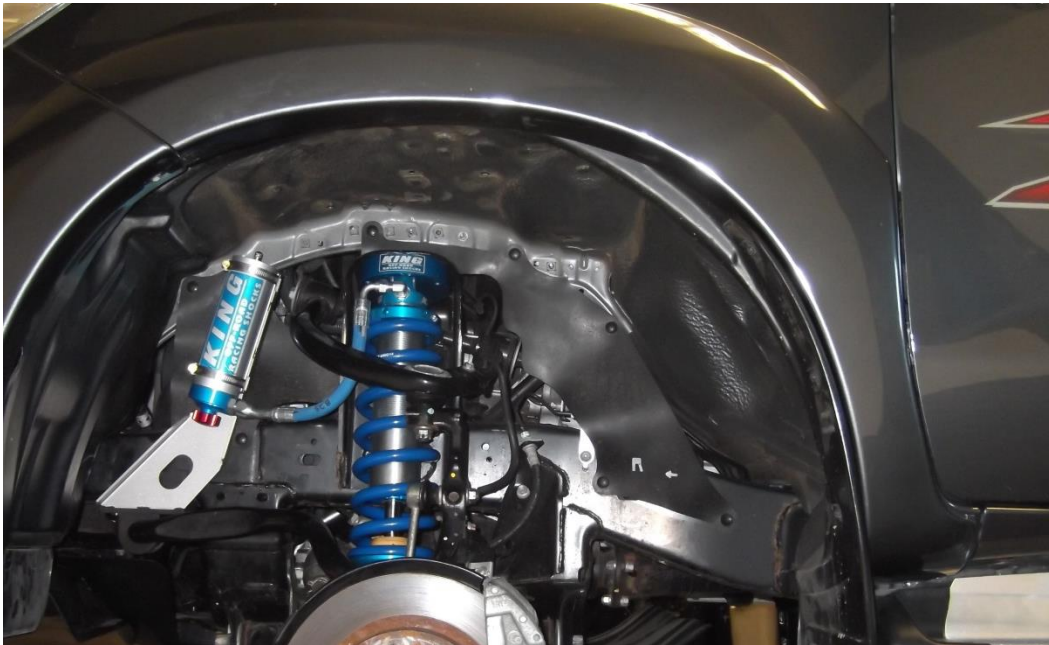

DOUBLE CHECK ALL HARDWARE: Make sure everything is installed correctly and all hardware is tight before reinstalling tires. Install tires, remove jack stands and lower vehicle to the ground. Recheck all hardware and lug nuts after 100 miles and periodically after that as part of routine maintenance.

Alignment is critical:

A professional alignment must be performed before driving this vehicle at highway speeds. Do not attempt to drive your vehicle after this install without having the alignment readjusted to factory specs!

IMPORTANT: Read all instructions thoroughly from start to finish before beginning the install. Check parts list and make sure all parts are included in the kit. If the instructions are not properly followed severe frame, driveline and or suspension damage may result. Check for frame and suspension damage prior to installation

This kit does not require welding. Do not weld on any component. Welding may void the warranty and/or cause the product to fail. If any parts are missing, or for tech assistance; Contact King Off Road Racing Shocks. 714-530-8701



2005 + Toyota Tacoma Rear Shocks

King Shocks 12472 Edison Way Garden Grove, CA 92841
714-530-8701 www.kingshocks.com



(1) With the vehicle on level ground and the front tires blocked, use a floor jack to raise the rear end and support the frame rails with jack stands for safety. Then remove the rear tires. **NOTE: Never work under an unsupported vehicle.**



(2) On the driver's side of the truck (left), remove the bolts holding the brake line bracket to the frame as shown. Insert the reservoir bracket between the brake bracket and the frame as shown. Replace the bolts and tighten. On the opposite side (right) mount the bracket with the provided hardware using the existing holes in the frame.

IMPORTANT: Read all instructions thoroughly from start to finish before beginning the install. Check parts list and make sure all parts are included in the kit. If the instructions are not properly followed severe frame, driveline and or suspension damage may result. Check for frame and suspension damage prior to installation

This kit does not require welding. Do not weld on any component. Welding may void the warranty and/or cause the product to fail. If any parts are missing, or for tech assistance; Contact King Off Road Racing Shocks. 714-530-8701



Installation Instructions (Page 2)

2005 + Toyota Tacoma Rear Shocks

King Shocks 12472 Edison Way Garden Grove, CA 92841
714-530-8701 www.kingshocks.com

(3)



(3)



(3) Remove the factory shocks by removing the hardware from the upper and lower mounts.

Note: Some Tacoma's have a clearance issue with the gusset in the rear lower shock mount. If your Tacoma has this issue it may be necessary to grind or bend the tab to make room for the lower rod end on your King Shocks. See Photos below.

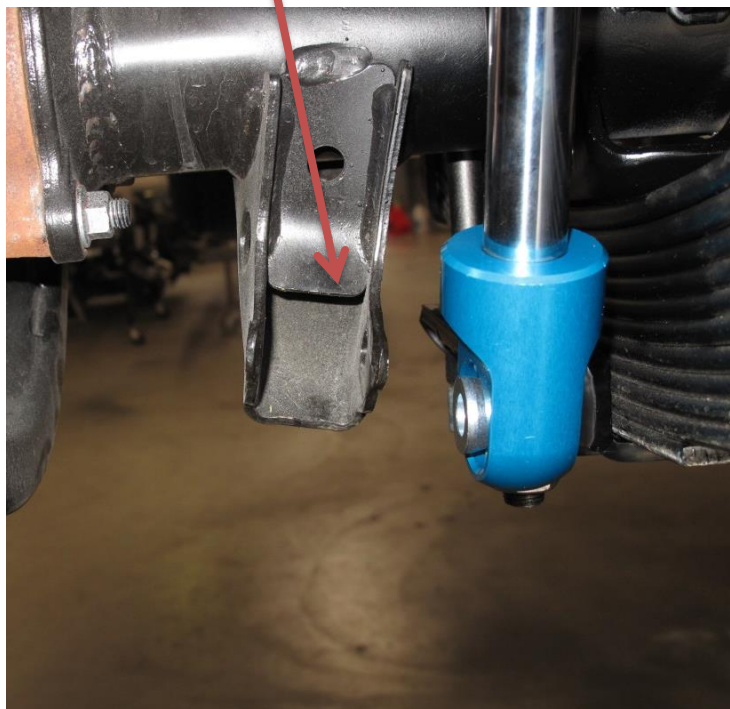

IMPORTANT: Read all instructions thoroughly from start to finish before beginning the install. Check parts list and make sure all parts are included in the kit. If the instructions are not properly followed severe frame, driveline and or suspension damage may result. Check for frame and suspension damage prior to installation

This kit does not require welding. Do not weld on any component. Welding may void the warranty and/or cause the product to fail. If any parts are missing, or for tech assistance; Contact King Off Road Racing Shocks. 714-530-8701



2005 + Toyota Tacoma Rear Shocks

King Shocks 12472 Edison Way Garden Grove, CA 92841
714-530-8701 www.kingshocks.com

(4)



(4) Install your King Shocks using the factory hardware for the lower mount and the supplied hardware for the upper mount. Make sure that you have a rubber bushing on each side of the upper shock mount. Attach the remote reservoir to the mount using the supplied band clamps as shown.

DOUBLE CHECK ALL HARDWARE:

Make sure everything is installed correctly and all hardware is tight before reinstalling tires. Install tires, remove jack stands and lower vehicle to the ground. Recheck all hardware and lug nuts after 100 miles and periodically after that as part of routine maintenance.

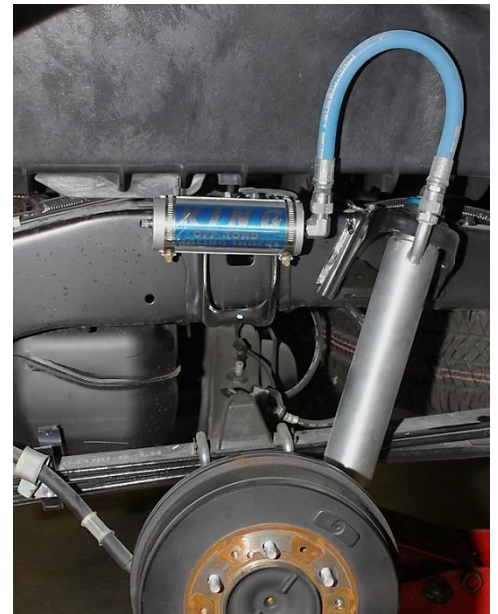

IMPORTANT: Read all instructions thoroughly from start to finish before beginning the install. Check parts list and make sure all parts are included in the kit. If the instructions are not properly followed severe frame, driveline and or suspension damage may result. Check for frame and suspension damage prior to installation

This kit does not require welding. Do not weld on any component. Welding may void the warranty and/or cause the product to fail. If any parts are missing, or for tech assistance; Contact King Off Road Racing Shocks. 714-530-8701

INSTALLATION INSTRUCTIONS

05+ TACOMA PRERUNNER/4WD U.C.A.

03+ 4RUNNER/07+ FJ CRUISER U.C.A.

TC-96504

DATE: 5/9/2007
REV.: 02
SCALE: N.T.S.
PAGE: 1 OF 4
DRAWN: SW

INSTALLATION DRAWINGS ARE FOR THE:
2005+ TACOMA PRERUNNER & 4WD
2003+ 4RUNNER 2WD/4WD
2007+ FJ CRUISER

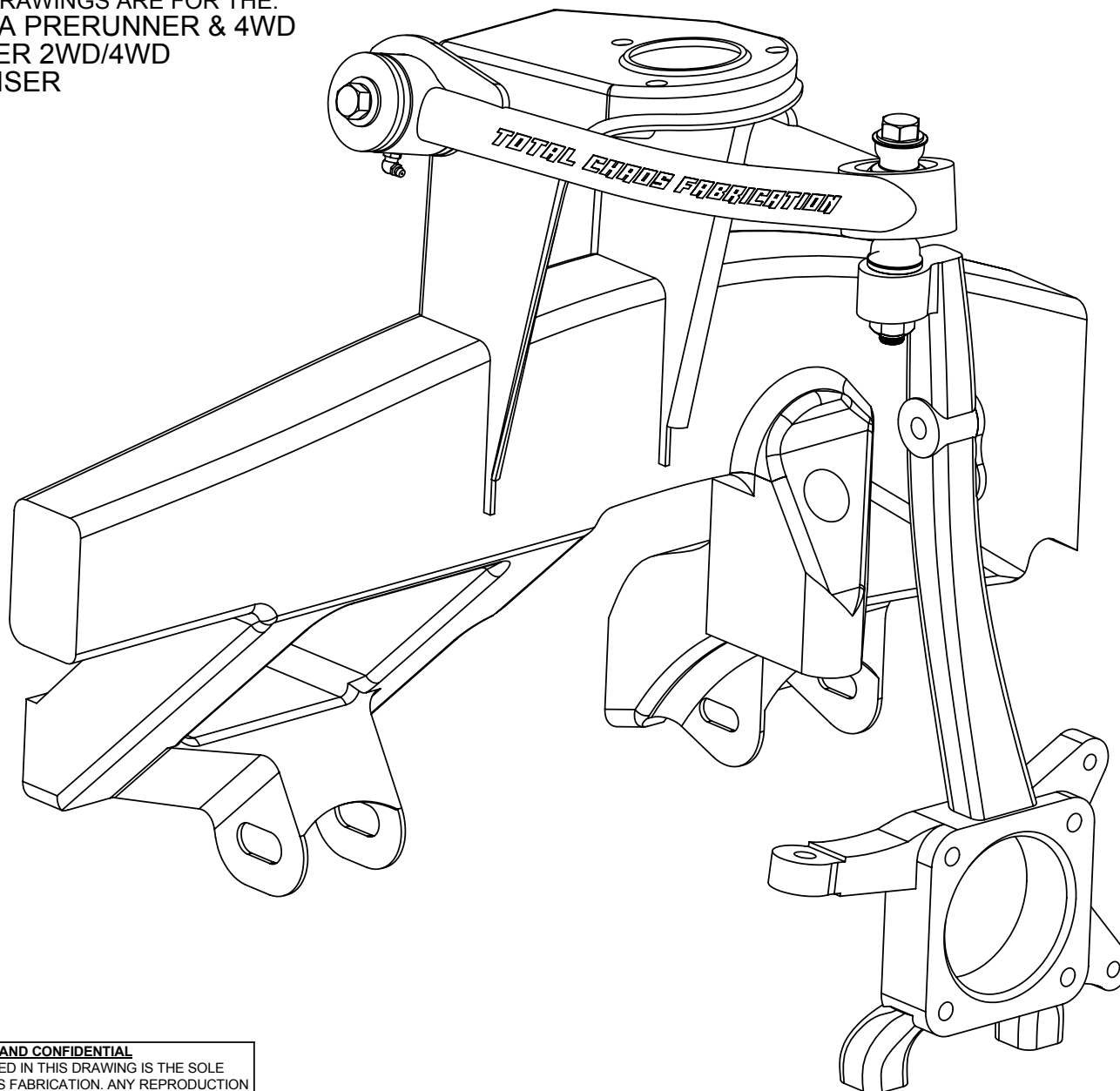

PROPRIETARY AND CONFIDENTIAL

THE INFORMATION CONTAINED IN THIS DRAWING IS THE SOLE PROPERTY OF TOTAL CHAOS FABRICATION. ANY REPRODUCTION IN PART OR AS A WHOLE WITHOUT THE WRITTEN PERMISSION OF TOTAL CHAOS FABRICATION IS PROHIBITED.

*LEFT SIDE OF TRUCK SHOWN. SOME ITEMS NOT SHOWN FOR CLARITY.

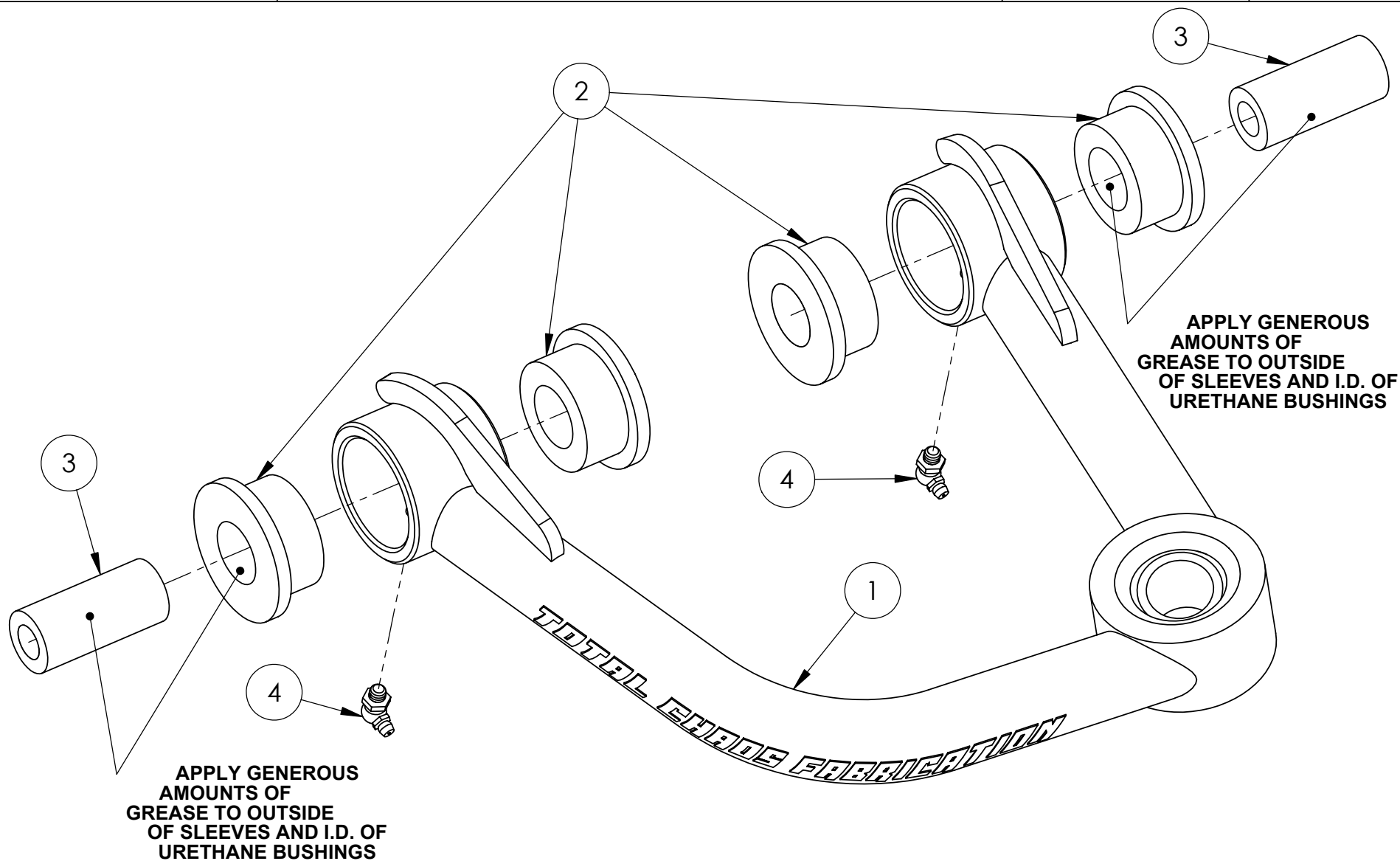

PROPRIETARY AND CONFIDENTIAL
THE INFORMATION CONTAINED IN THIS DRAWING IS THE SOLE PROPERTY OF TOTAL CHAOS FABRICATION. ANY REPRODUCTION IN PART OR AS A WHOLE WITHOUT THE WRITTEN PERMISSION OF TOTAL CHAOS FABRICATION IS PROHIBITED.

*LEFT SIDE OF TRUCK SHOWN. SOME ITEMS NOT SHOWN FOR CLARITY.

Important Note:

When removing the factory upper control arm bolt, you will need to bend the inner fender well on both sides of the truck. Once installation is complete, bend it back to its original position.

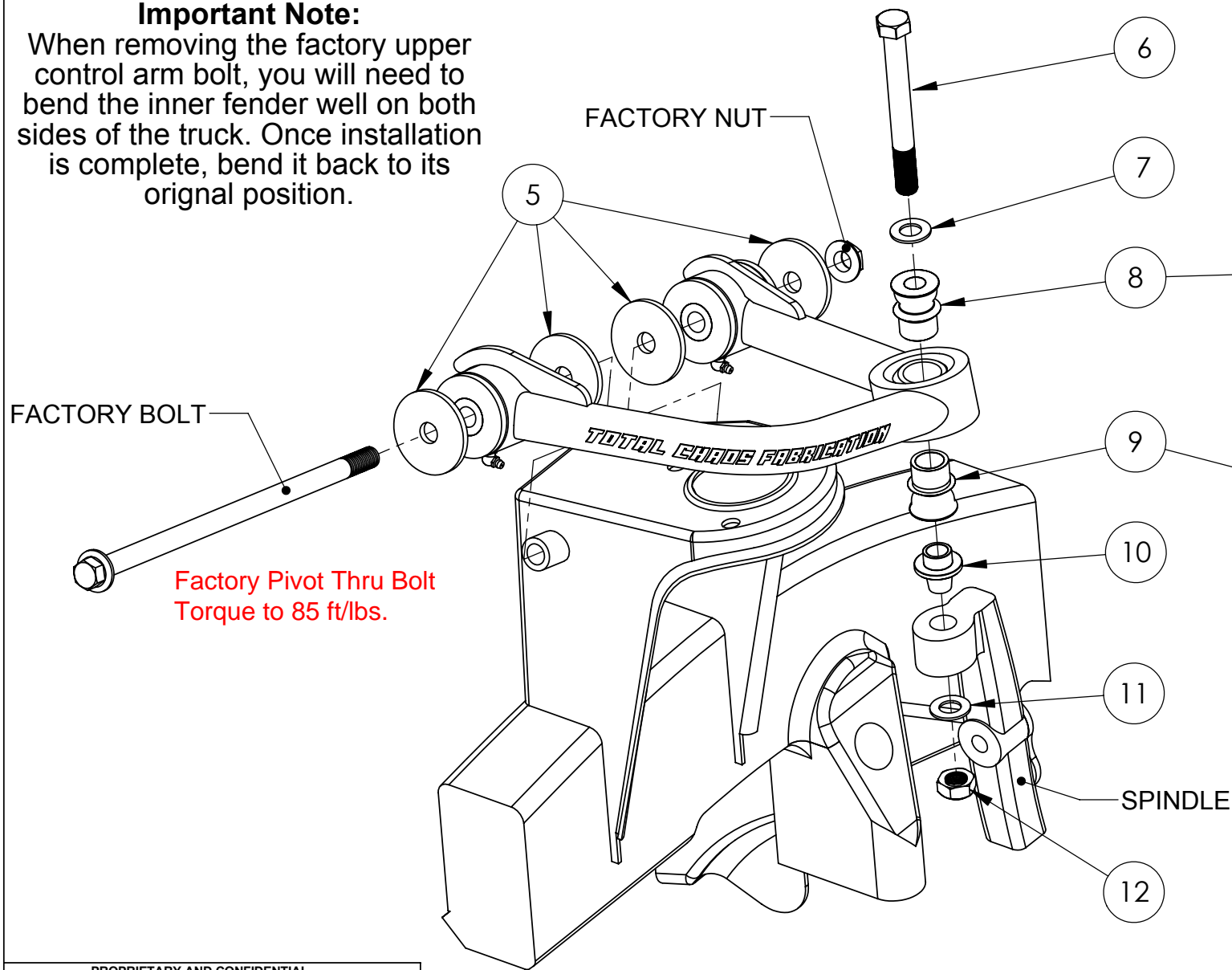

IMPORTANT NOTE:
During assembly, upper & lower spacers are specific. Failure to follow these instructions will result in damage of all components.

Upper spacer has 9/16" hole

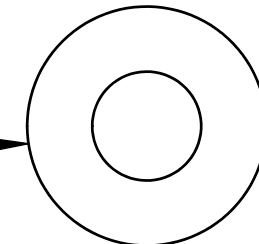

Lower spacer has 3/4" hole

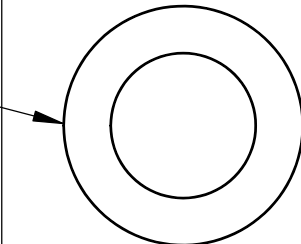

PROPRIETARY AND CONFIDENTIAL

THE INFORMATION CONTAINED IN THIS DRAWING IS THE SOLE PROPERTY OF TOTAL CHAOS FABRICATION. ANY REPRODUCTION IN PART OR AS A WHOLE WITHOUT THE WRITTEN PERMISSION OF TOTAL CHAOS FABRICATION IS PROHIBITED.

*LEFT SIDE OF TRUCK SHOWN. SOME ITEMS NOT SHOWN FOR CLARITY.

INSTALLATION NOTES

The factory manual is required for torque specifications on all factory hardware. This procedure will involve the removal and re-installation of many parts. Always use factory replacements for worn or damaged parts.

Some items are not shown for clarity.

Page 2

Apply generous amounts of grease to outside of sleeves and I.D. of urethane bushings.

Page 3

Torque Item# 6 to 100 ft/lbs.

Inspect all components and re-torque all hardware within 500 miles.

PARTS LIST: 05+ TACO/FJ/4RUN UPPER CONTROL ARM

ITEM #	PART #	QTY.	ITEM DESCRIPTION
1	99654L	1	CONTROL ARM, 05+ TACOMA UPPER LEFT
	99654R	1	CONTROL ARM, 05+ TACOMA UPPER RIGHT
2	60684	8	BUSHING, URETHANE HALF
3	69120	4	INNER SLEEVE
4	10005	4	FITTING, GREASE (ZERK)
5	69620	8	WASHER, PLATED PIVOT END
6	10251	2	BOLT, 9/16" x 5.00L
7	12203	2	WASHER, 9/16" AN
8	100916	2	SPACER, 9/16" MISALIGNMENT
9	10034TCF	2	SPACER, 3/4" MISALIGNMENT
10	30004	2	SLEEVE, 9/16" TAPERED ADAPTER
11	12204	2	WASHER, 9/16" SAE
12	11202	2	NUT, 9/16" C-LOCK

TOTAL CHAOS Fabrication Inc.
159 North Maple St. Unit J
Corona, CA 92880
951.737.9682

PROPRIETARY AND CONFIDENTIAL

THE INFORMATION CONTAINED IN THIS DRAWING IS THE SOLE PROPERTY OF TOTAL CHAOS FABRICATION. ANY REPRODUCTION IN PART OR AS A WHOLE WITHOUT THE WRITTEN PERMISSION OF TOTAL CHAOS FABRICATION IS PROHIBITED.

*LEFT SIDE OF TRUCK SHOWN. SOME ITEMS NOT SHOWN FOR CLARITY.



ADD-A-LEAF INSTALLATION INSTRUCTIONS

support@toyteclifts.com

Prior to installation, please read all install directions and paperwork provided.

ToyTec Lifts L.L.C. recommends that all components be installed by a certified automotive technician.

1. Park on a level concrete surface with the tires straight and steering wheel locked in the center position.
2. Block/chock the front wheels, both in front and behind the tire to prevent vehicle movement.
3. Jack the rear end of your vehicle up using a floor jack positioned on the axle pumpkin. Secure the vehicle on suitable large jack stands from the frame on both sides. Leave the floor jack under the axle pumpkin with some upwards pressure on it.
4. Remove both rear wheels/tires.
5. Disconnect the E-brake cable via the pins attached to the drum brake levers on both sides (**'95.5-'04 Tacoma only**).
6. Remove the shocks on both sides.
7. Be certain that the axle is well supported and remove the axle U-bolts, axle plates, bump stops, and all hardware on both sides. Slowly lower the axle so there is enough room between the spring perch and spring to install the add-a-leafs. **Be careful not to overextend the rear soft brake line leading from the axle to the frame!**
8. Using 2 large C-clamps hold the spring assembly securely together on each side of the spring centering bolt. Loosen and remove the bolt. A pair of vice grips may be needed to hold the center bolt head from spinning while removing the nut.
9. Taking note as to the order the leaf pack is assembled, carefully loosen and remove the C-clamps. Note the placement of any shims or spring dividers for re-assembly. **If your factory leaf springs have a roll pin through the leaf springs, it will need to be removed and discarded**
10. Apply a small amount of grease to the friction pads of the add-a-leaf and place it in the correct place within the leaf pack.
11. **Note that the add-a-leaf must be placed in the correct order- Longest leaf being on top (main leaf) and progressing to the shortest on the bottom (overload spring). The add-a-leaf should be below the main leafs and above the short thick overload leaf. IF YOUR ADD-A-LEAF HAS A LONGER SIDE THAN THE OTHER, THE LONGER END OF THE ADD-A-LEAF SHOULD BE FACING TOWARD THE REAR OF THE TRUCK. DO NOT INSTALL THE ADD-A-LEAF BELOW THE OVERLOAD SPRING!**
12. Use a screwdriver or small punch and line up the individual leafs and then slide the center pin up through the leafs. Squeeze the thinner leafs within the pack together using C-clamps, continually aligning the center holes. **NOTE: If your lift kit is supplied with the solid steel axle shims, place the center bolt through the shim center hole prior to installing the center pin in the leaf pack. The thinner end of the shim should face toward the front of the vehicle.**

13. **USE C-CLAMPS TO PULL THE SPRING PACK TOGETHER, NOT THE SPRING CENTER BOLT!** Torque the center bolt to manufacturer specs and cut most of the remaining threads off the centering bolt so the bump stop fits correctly.



14. Re-install all bump stops, U-bolts, axle plates, washers, and nuts. Torque U-bolt nuts to manufacturer specs.
15. If your kit came with a Brake Proportioning Valve Bracket Kit now is a good time to install this.
16. Re-install shocks, E-brake cables, and rear wheels. Torque all bolts and lug nuts to manufacturer specs.
17. Lower the vehicle and test drive.

Recheck the torque of all bolts/nuts which have been taken apart during the installation of this lift after 15 miles, and periodically thereafter.



Diff-Drop Kit Installation Instructions:

2005+ Tacoma, 07+ FJ, 03+ 4Runner

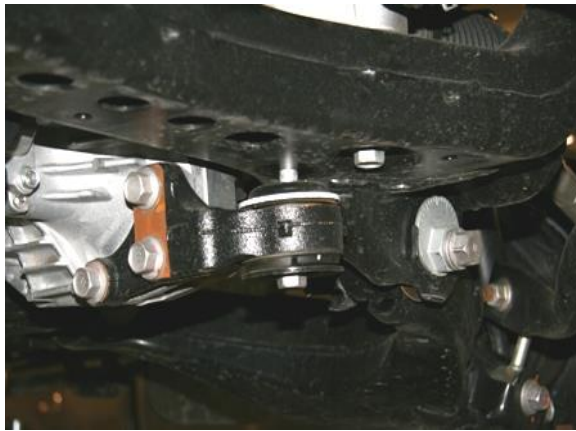

Stock (fig. 1)



Diff Drop kit Installed (Fig. 2)

1. Remove skid plate from front of the vehicle, save the OEM bolts.
2. Support the differential with a floor jack
3. Remove factory M14 bolts and nuts, supporting the front differential, see Fig. 1 above for the stock configuration. Save the OEM washers for re installation.
4. Lower differential far enough to allow insertion of the 1" drop spacers.
5. Install the 1" spacers between the two front differential supports and front cross-member. (see Figure 2 above) . Fasten to cross-member using new 1/2" x 6" long Grade 8 bolts and nuts (making sure to reuse the factory washers). Tighten to the factory specifications (If you don't have the factory specs, 80-90 ft.lbs. should be adequate for this size/grade bolt) Figure 2 shows the diff drop kit installed.
6. Install the front skid plate using the OEM bolts on the front and the supplied longer bolts with washers and skid spacers on the rear mounting point.
7. Install rear skid plate using the small supplied spacers and longer bolts with washers between the frame and skid plate on the front and the OE bolts on the rear of the skid plate to prevent skid plate to differential mounting bracket interference.
8. Skid plate trimming may be required on some models.
9. Torque all skid plate bolts to factory specifications. (25 ft lbs should be adequate.)

3 Degree Rear Axle Shims installation Instructions:

Place the center bolt through the shim center hole prior to installing the center pin in the leaf pack. The thinner end of the shim should face toward the front of the vehicle.